

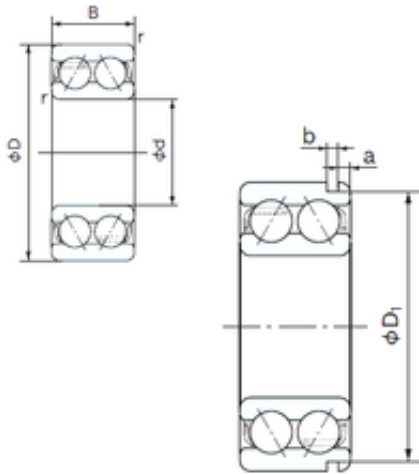

Shandong Chik Bearing Co., Ltd.



55 mm x 100 mm x 33.3 mm NACHI 5211AN angular contact ball bearings

Bearing No. 5211AN

5211AN Bearing 2D drawings and 3D CAD models

Size	55x100x33.3 mm
Bore Diameter	55 mm
Outer Diameter	100 mm
Width	33.3 mm
d	55 mm
D	100 mm
B	33.3 mm
C	33.3 mm
a	3.28 mm
b	2.7 mm
r min.	1.5 mm
D1	96.8 mm
Weight	0.960 Kg
Basic dynamic load rating (C)	63,5 kN
Basic static load rating (C0)	53 kN
(Grease) Lubrication Speed	4000 r/min
Bore Type	Cylindrical Bore
Enclosure	Open
Configuration	Double Row
Bore Size	55 mm
Outside Diameter	100 mm
Width	33.3 mm
Fillet Radius/Chamfer	1.5 mm
Groove Width	2.7 mm
Groove Diameter	96.8 mm



Shandong Chik Bearing Co., Ltd.

a (max)	3.3 mm
Dynamic Load Rating	63,500 N
Static Load Rating	53,000 N
Limiting Speed - Grease	4,000 rpm
Limiting Speed - Oil	5,500 rpm
Radial Clearance	0.008 to 0.028 mm
da	64 mm
Da	91 mm
Dx	108 mm
ra	1.5 mm
Cy	5.4 mm