

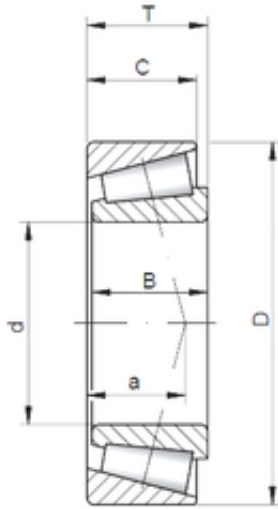

Shandong Chik Bearing Co., Ltd.



200,025 mm x 384,175 mm x 112,712 mm ISO
H247535/10 tapered roller bearings

Bearing No. H247535/10

Size	200.025x384.175x112.712 mm
Bore Diameter	200,025 mm
Outer Diameter	384,175 mm
Width	112,712 mm
d	200,025 mm
D	384,175 mm
T	112,712 mm
B	112,712 mm
C	90,488 mm
a	27,9 mm

H247535/10 Bearing 2D drawings and 3D CAD models