

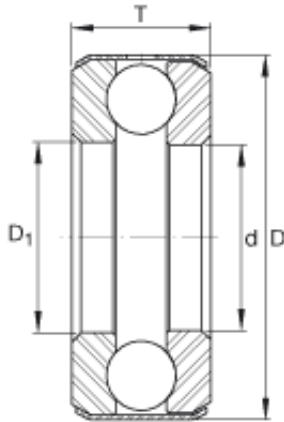

# Shandong Chik Bearing Co., Ltd.



## INA D32 thrust ball bearings

Bearing No. D32

D32 Bearing 2D drawings and 3D CAD models

Size	61.913x97.638x20.65 mm
Bore Diameter	61,913 mm
Outer Diameter	97,638 mm
Width	20,65 mm
d	2 7/16 inch
d	61,913 mm
D	3,844 inch
D	97,638 mm
T	0,813 inch
T	20,65 mm
D <sub>1</sub>	2,469 inch
m	1,19 lbs / Weight
m	538 g / Weight
C <sub>a</sub>	11500 lbf / Dynamic load rating (axial)
C <sub>a</sub>	51000 N / Dynamic load rating (axial)
C <sub>0a</sub>	32500 lbf / Static load rating (axial)
C <sub>0a</sub>	145000 N / Static load rating (axial)
Category	Thrust Ball Bearing
Inventory	0.0
Manufacturer Name	SCHAEFFLER GROUP
Minimum Buy Quantity	N/A
Weight / Kilogram	0.54
Product Group	B04270



## Shandong Chik Bearing Co., Ltd.

Rolling Element	Ball Bearing
Thrust Bearing	Yes
Single or Double Direction	Single Direction
Banded	Yes
Precision Class	ABEC 1   ISO P0
Component Description	Roller Assembly Plus Raceways
Other Features	Single Row   Deep Groove   Medium Cross Section   Grooved Race   Non Separable   Full Complement   Standard Oil Hole in Band
Long Description	2-7/16" Bore 1; 2-15/32" Bore 2; 3-27/32" Outside Diameter; 13/16" Height; Ball Bearing; Single Direction; Banded; ABEC 1   ISO P0 Precision
Inch - Metric	Inch
Category	Thrust Ball Bearings
UNSPSC	31171507
Harmonized Tariff Code	8482.10.50.08
Noun	Bearing
Keyword String	Ball Thrust
Manufacturer URL	<a href="http://www.ina.com">http://www.ina.com</a>
Manufacturer Item Number	D32
Weight / LBS	1.19
Bore 2	2.469 Inch   62.713 Millimeter
Bore 1	2.438 Inch   61.925 Millimeter
Overall Height with Aligning Washer	0 Inch   0 Millimeter
Outside Diameter	3.844 Inch   97.638 Millimeter
Height	0.813 Inch   20.65



# Shandong Chik Bearing Co., Ltd.

	Millimeter
--	------------