

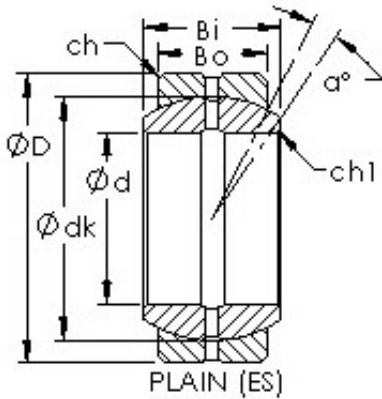

Shandong Chik Bearing Co., Ltd.



AST GEZ50ES plain bearings

Bearing No. GEZ50ES

Bore Diameter	50,8 mm
Outer Diameter	80,9625 mm
Bearing Type	plain
Bore Dia (d)	2.0000
Outer Dia (D)	3.1875
Outer Width (Bo)	1.5000
Inner Width (Bi)	1.7500
Dynamic Load Rating (Cr)	50,354
Static Load Rating (Cor)	150,613
Max. shaft corner radius, or 45 deg. chamfer (ch1)	0.024
Max. housing corner radius, or 45 deg. chamfer (ch)	0.040
Spherical Diameter (dk or Dk)	2.874
Mis-alignment Angle (α deg.)	6
Weight (g)	930.00
Material	52100 Chrome steel, or equivalent

GEZ50ES Bearing 2D drawings and 3D CAD models