

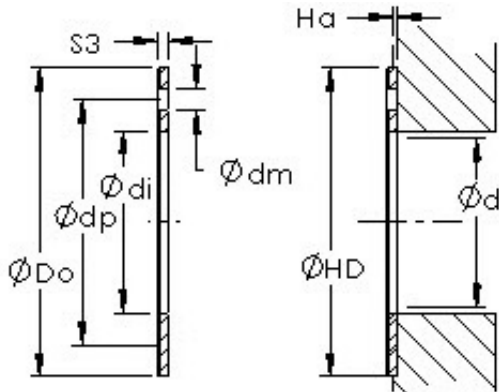

Shandong Chik Bearing Co., Ltd.



AST AST50 WC10IB plain bearings

Bearing No. AST50 WC10IB

Bore Diameter	15,875 mm
Bearing Type	thrust washer
Shaft Dia., Nominal (d)	0.6250
Bearing Outside Dia., Nominal (D)	1.2500
Washer Inside Diameter, Nominal (di)	1
Washer Inside Diameter Tolerance (di tol.) - +.010 / -0	
Washer Outside Diameter, Nominal (Do)	1
Washer Outside Diameter Tolerance (Do tol.) - +0 / -.010	
Washer Thickness, Nominal (S3)	0
Washer Thickness Tolerance (S3 tol.) - +.001 / -.001	
Mounting Hole Dia. (dm)	0.099
Mounting Hole Pitch Dia. (dp)	1.005
Housing Counterbore Depth (Ha)	0.04
Housing Counterbore Depth Tolerance (Ha tol.) - +.010 / -.010	
Housing Counterbore Diameter, Nominal (HD)	1.250
Housing Counterbore	+0.010 / 0

AST50 WC10IB Bearing 2D drawings and 3D CAD models



Shandong Chik Bearing Co., Ltd.

Diameter Tolerance (HD tol.) - $+0.010 / -0$	
Material	Carbon steel shell with PTFE / Fiber lining